



Footscray Road, New Eltham, SE9

Guide Price £550,000

3 1 1



- Three Bedroom House
- Open Plan Larger Than Average Reception Room
- Extended Kitchen
- Generous Sized Garden
- Off Street Parking For Numerous Vehicles
- New Eltham Railway Station & Village Shops Within Walking Distance
- Excellent Bus Links Keeping You Connected With Eltham, Greenwich & Sidcup
- Catchment Area For Highly Regarded Schools
- EPC Rating E - Potential B
- Council Tax Band E - Royal Borough Of Greenwich



***** GUIDE PRICE £550,000 - £575,000 *****

Charming Three-Bedroom Semi-Detached House in London SE9 2SX

Discover the perfect family home at Footscray Road. This stunning three-bedroom semi-detached house offers a delightful blend of space, style, and convenience. With its spacious reception room, extended kitchen, generous garden, off-street parking, and excellent location, it's an opportunity you won't want to miss.

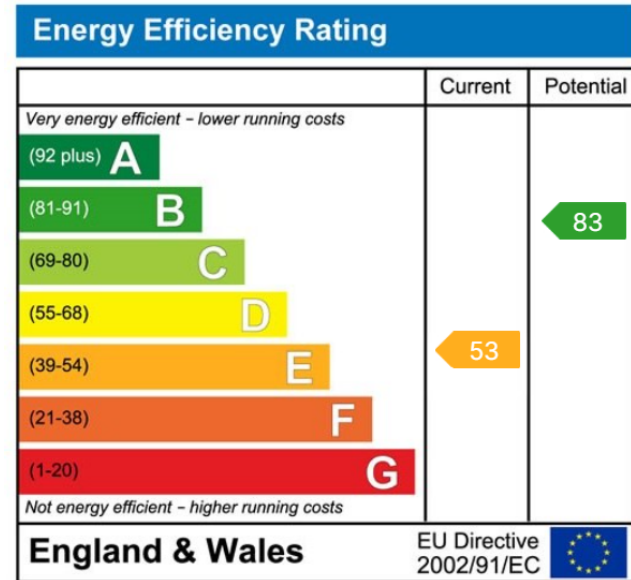
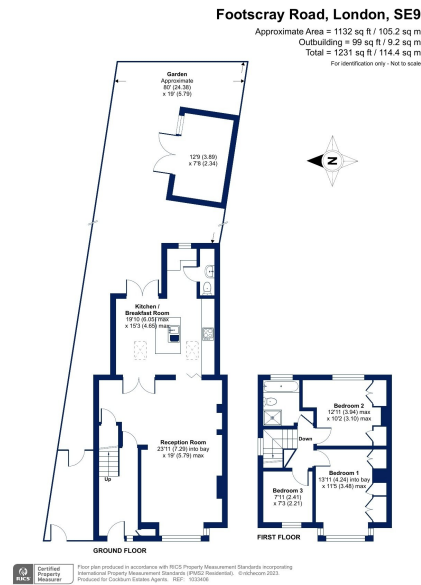

Cockburn EA
 352 Footscray Road,
 London, SE9 2EB
 t: **020 8859 8590**