





Cross Park, Filham Chase, Ivybridge, PL21 0WL

£520,000

 4  2  2



"The Warton" A 4 bedroom brick built detached former show house serving this popular Bloor Home development on eastern side of Ivybridge, convenient to local amenities. The house is beautifully presented offering an entrance hall with utility cupboard, cloakroom, living room and open plan kitchen, family and ding area on the ground floor, together with landing, 4 piece family bathroom, 4 bedrooms and en suite shower/WC on the upper floor. The house is Upvc double glazed and gas centrally heated. Externally there is a small front garden, long private drive to the garage and a fabulous westerly facing garden. EPC B 84.



Key Features

- "The Warton" Former Show Home
- En Suite Shower/WC
- 4 Piece Modern Bathroom Suite
- Upvc Double Glazing
- Long Driveway And Single Garage
- 4 Bedroom Detached House
- Feature Integrated Kitchen/Dining/Family Room
- Cloakroom
- Feature Enclosed Westerly Facing Garden
- EPC B 84

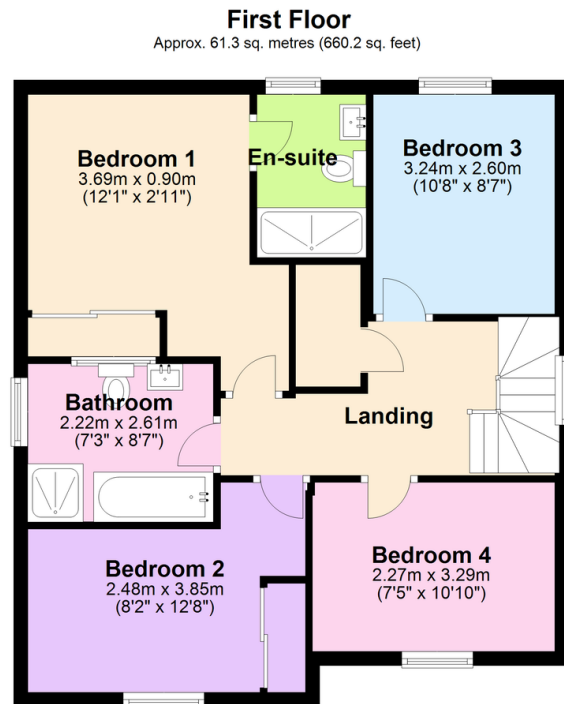
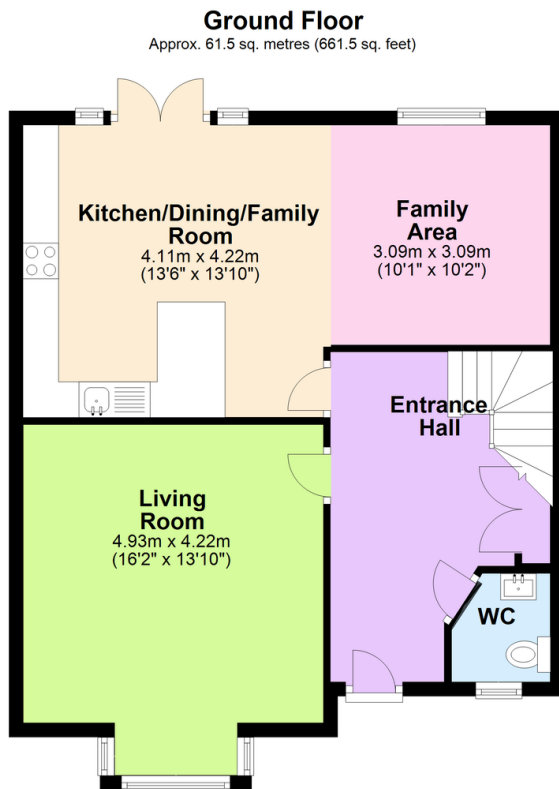

Total area: approx. 122.8 sq. metres (1321.7 sq. feet)