



## Knighton Road, St Judes, Plymouth, PL4 9DA

Guide Price £230,000

3 1 2



Nestled in an enviable central location, this charming three-bedroom Victorian terrace family home offers a perfect blend of period character and modern convenience. The ground floor welcomes you with two spacious reception rooms, alongside a contemporary fitted kitchen. Upstairs, three well-proportioned bedrooms provide ample space for family living, complemented by a modern family bathroom. This home retains many of its original features, adding to its unique charm and appeal. To the rear of the property there is a southerly facing courtyard which has double gates at the rear, providing an added bonus of secure off-road parking if required, although there is on road parking available to the front of the property. EPC D 65.



# MILLINGTON TUNNICLIFF

[www.millingtontunncliff.co.uk](http://www.millingtontunncliff.co.uk)

## Key Features

- Three Bedroom Victorian Property
- Modern Fitted Kitchen
- Southerly Facing Courtyard
- On Road Parking (Permit Required During The Week)
- Walking Distance To Tothill Park
- Lounge & Dining Room
- Family Bathroom
- Character Features
- Central Location
- Gas Central Heating & Double Glazing

### Ground Floor

Approx. 38.3 sq. metres (412.2 sq. feet)

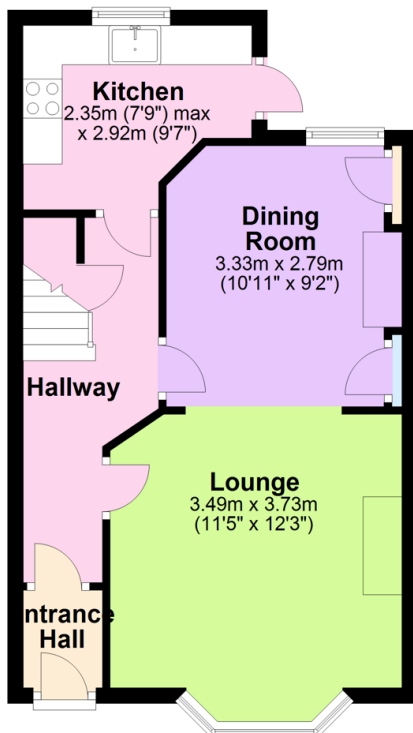

### First Floor

Approx. 39.3 sq. metres (422.5 sq. feet)

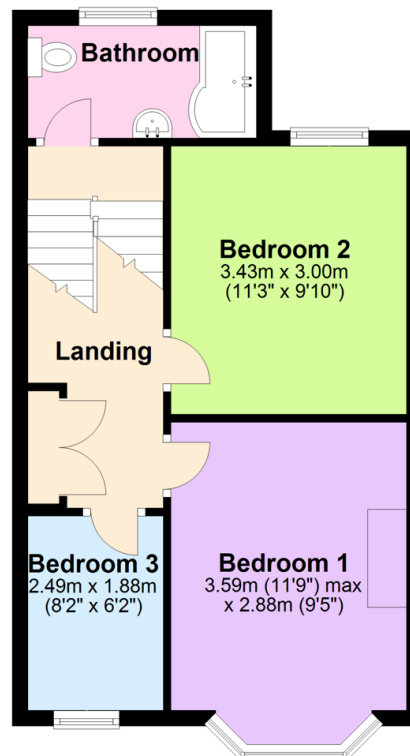

Total area: approx. 77.6 sq. metres (834.7 sq. feet)

01752 896020 | [info@millingtontunncliff.co.uk](mailto:info@millingtontunncliff.co.uk) | 19 Fore Street, Ivybridge, Devon, PL21 9AB