





# MILLINGTON TUNNICLIFF

[www.millingtontunnicliff.co.uk](http://www.millingtontunnicliff.co.uk)

## 31 St. Margarets Road, Woodford

£280,000

 3  1  2



A 3 bedroom extended semi detached bungalow set within this popular part of Plympton convenient for local facilities and amenities. The property has spacious accommodation to include an entrance porch, hall, wet room, 3 bedrooms, dining room and extended living room and modern integrated kitchen. The property is Upvc double glazed and gas centrally heated. Externally there are gardens and a single garage. EPC D 60.

01752 896020 | [info@millingtontunnicliff.co.uk](mailto:info@millingtontunnicliff.co.uk) | 19 Fore Street, Ivybridge, Devon, PL21 9AB



## Key Features

- 3 Bedroom Semi Detached Bungalow
- Extended Living Room
- Wet Room
- Modern Integrated Kitchen
- Upvc Double Glazing
- Gas Central Heating
- Garage
- South/Westerly Facing Garden
- No Chain
- EPC D 60

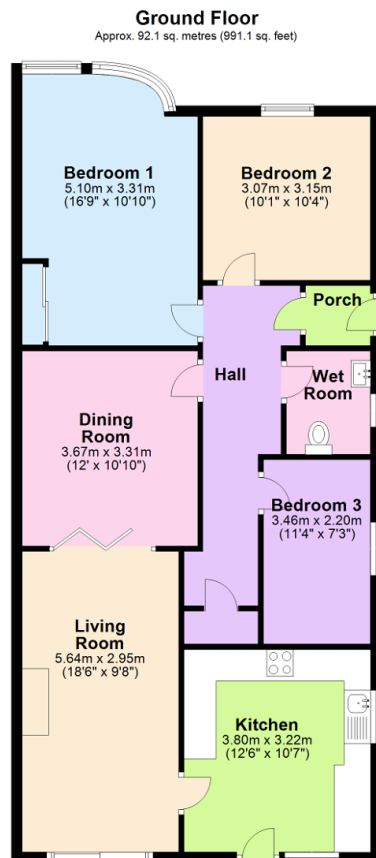

Total area: approx. 92.1 sq. metres (991.1 sq. feet)