





Okehampton Way, Ivybridge, PL21 0YN

£329,950

 3  2  1



Offered for sale with no onward chain is this three bedroom detached family home with garage and driveway. The property offers a spacious lounge, kitchen/diner, double glazed conservatory, downstairs WC, three bedrooms of which the master benefits from an en-suite and family shower room. Outside there is an attractive rear garden with storage shed. EPC D 64.



MILLINGTON TUNNICLIFF

www.millingtontunncliff.co.uk

Key Features

- Detached Family Home
- Lounge With Fireplace
- Double Glazed Conservatory
- Well Maintained Gardens
- Garage & Driveway
- Three Bedrooms
- Kitchen/Diner
- Family Shower Room and Master En-Suite
- Triple Glazing Throughout
- No Onward Chain

Ground Floor

Approx. 46.8 sq. metres (504.1 sq. feet)

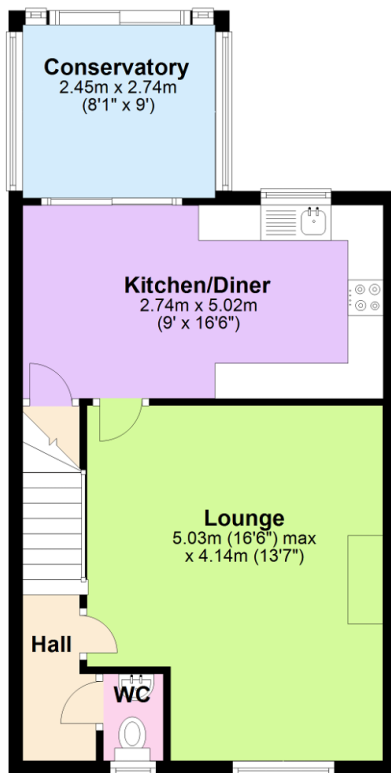

First Floor

Approx. 40.2 sq. metres (433.0 sq. feet)

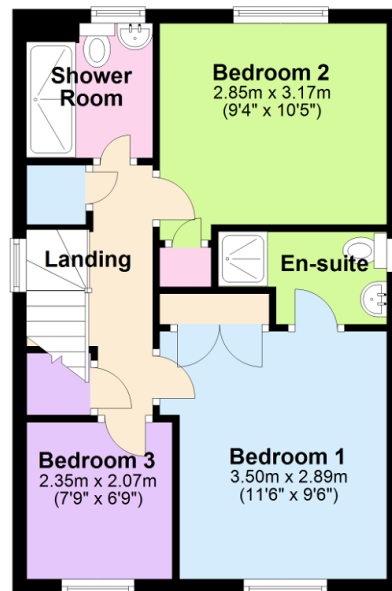

Total area: approx. 87.1 sq. metres (937.1 sq. feet)

01752 896020 | info@millingtontunncliff.co.uk | 19 Fore Street, Ivybridge, Devon, PL21 9AB