





MILLINGTON TUNNICLIFF

www.millingtontunnickliff.co.uk

Edgemill Walk, Lucerne Fields, Ivybridge, PL21 0GN

£285,000

 3  2  1



A modern 3 bedroom semi detached house built by Barratt Homes on the eastern side of Ivybridge, convenient for local amenities. The house offers an entrance hall, cloakroom, living room and kitchen/diner on the ground floor, together with landing, the 3 bedrooms, family bathroom and en suite shower room on the upper floor. There is a gas central heating system and Upvc double glazing. There is a driveway at side allowing for off road parking and an enclosed garden at rear. EPC B 84.

01752 896020 | info@millingtontunnickliff.co.uk | 19 Fore Street, Ivybridge, Devon, PL21 9AB



MILLINGTON TUNNICLIFF

www.millingtontunncliff.co.uk

Key Features

- Modern 3 Bedroom Semi Detached House
- Cloakroom
- Upvc Double Glazing
- Driveway At Side Allowing For Off Road Parking
- EPC B 84
- En Suite Shower/WC
- Modern Kitted Kitchen/Diner
- Gas Central Heating
- Popular Cul De Sac On Eastern Side Of Ivybridge
- Convenient To Local Amenities

Ground Floor

Approx. 36.7 sq. metres (395.0 sq. feet)

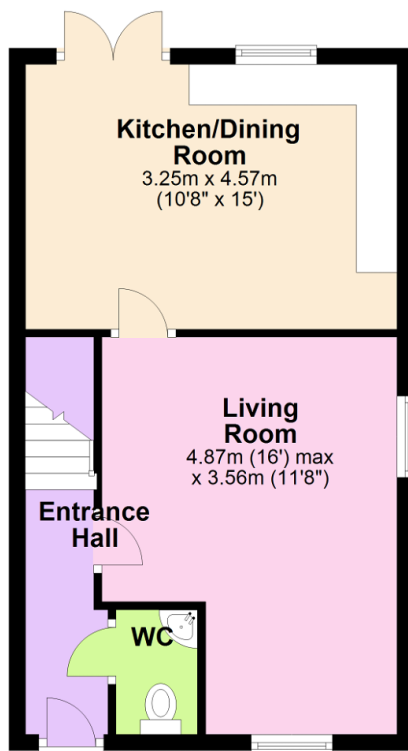

First Floor

Approx. 37.6 sq. metres (404.8 sq. feet)

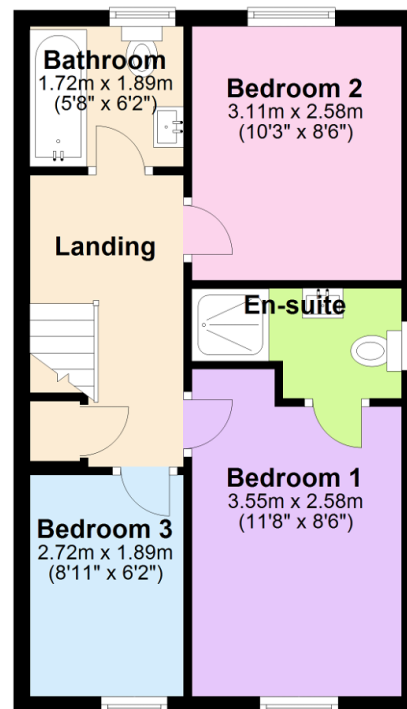

Total area: approx. 74.3 sq. metres (799.7 sq. feet)

01752 896020 | info@millingtontunncliff.co.uk | 19 Fore Street, Ivybridge, Devon, PL21 9AB