



CLASPAVE SAVILLE
ESTATE AGENTS

38 Southport Road

Fixed Price £435,000

🛏️ 3 🚿 3 🚗 1



- Exceptional Three Bedroom Detached Bungalow
- Two Ensuite Shower Rooms
- Utility Room
- Artificial Grass (Rear Garden Not Overlooked)
- No Chain
- Stunning Kitchen/Dining
- Spacious Family Bathroom
- Boiler/Storage Room
- Spacious Carriage Driveway
- EPC Pending, Council Tax Band D



EXCEPTIONAL! EXTENDED DETACHED BUNGALOW, A CREDIT TO THE CURRENT OWNER, THREE GOOD SIZED BEDROOMS TWO WITH EN SUITE, OPEN PLAN KITCHEN/DINER WITH BI FOLD DOORS TO THE GARDEN, UTILITY ROOM, SEPERATE LIVING ROOM, STUNNING BATHROOM, CARRIAGE DRIVEWAY, ENCLOSED GARDENS WITH ARTIFICIAL GRASS. MUST BE VIEWED INTERNALLY! Having been extended and totally renovated by the current vendor to an exceptionally high standard, this property is a must see for anyone looking to move straight into a perfect bungalow. The accommodation comprises porch, entrance hallway, lounge, gorgeous open plan kitchen/diner, utility Room, Three good sized bedrooms two with en-suite and a family bathroom. Externally there is a carriage driveway and enclosed gardens to the rear which enjoy a large patio area, artificial lawns.

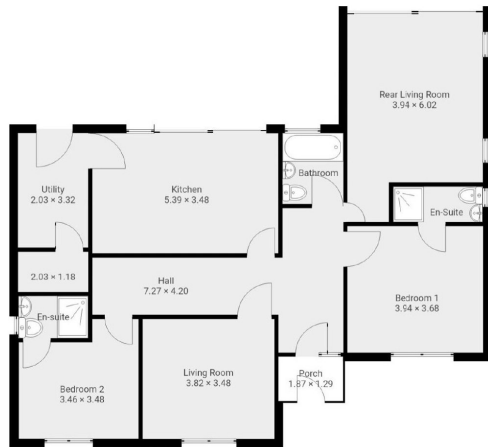

38 Southport Road, L31 2HZ

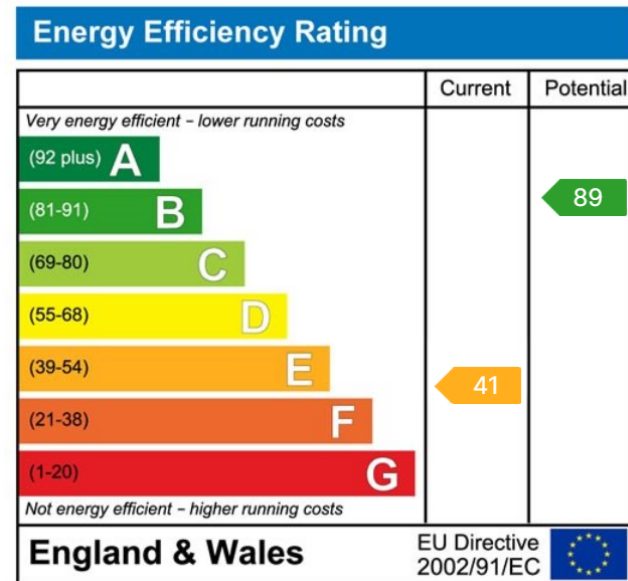

Alastair Saville Estate Agents
 25 Central Square • Maghull • Liverpool • L31 0AE
 138 Ormskirk Road • Old Roan • Liverpool • L10 3JG
 Tel: 0151 520 0001 • Website: www.alastairsaville.com
 Email: sales@alastairsaville.com • lettings@alastairsaville.com

