



ALASTAIR SAVILLE
ESTATE AGENTS

Dartmouth Avenue, Old Roan

£225,000

🛏 2 🚿 1 🚗 1



SEMI DETACHED, TWO BEDROOM BUNGALOW, USEFUL LOFT SPACE, ENCLOSED GARDENS TO THE REAR, DRIVEWAY AND GARAGE, SOUGHT AFTER LOCATION, NO ONWARD CHAIN.

This semi detached bungalow sits in the tucked away location of Dartmouth Avenue, close to all of the local amenities. The accommodation comprises entrance hallway, lounge, conservatory, kitchen/diner, two bedrooms and a shower room to the ground floor. To the first floor is a loft space loosely divided into three rooms. Externally, there is a paved garden to the front, a driveway providing off road parking and giving access to the garage. To the rear are lovely



ALASTAIR SAVILLE
ESTATE AGENTS

enclosed gardens which are again mainly laid to lawn with a large patio area. Being ideal for anyone wanting versatile accommodation, we would recommend an early viewing.



ALASTAIR SAVILLE
ESTATE AGENTS

Key Features

- Semi Detached Bungalow
- Useful Loft Space
- Enclosed Gardens
- Potential To Extend
- EPC Rating- Pending
- Two Bedrooms
- In Need Of Some Modernising
- Driveway And Garage
- No Onward Chain
- Council Tax Band- C

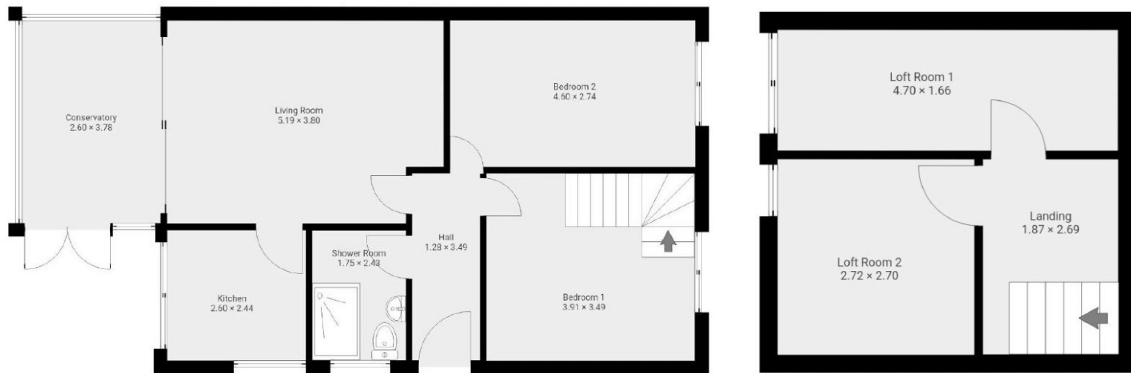

25 Dartmouth Avenue, L10 2JU