



ADAM HALLIWELL POWERED BY **exp** TM UK

@ adam.halliwell@exp.uk.com

adamhalliwell.exp.uk.com

01242 906 586

The Cornfields, Bishops Cleeve, Cheltenham, GL52

£215,000

🛏️ 1 🚿 1 🚗 1



- Please quote ref AH0137.
- Immaculate terraced property
- Double bedroom with built-in cupboard
- Modern bathroom with rain shower and bath
- Refitted kitchen with modern appliances
- 36' rear garden with gated access
- Useful landing/study area
- Allocated parking space
- Overlooking a green
- End of the cul de sac



This immaculate terraced property at the end of a cul de sac is perfect for couples, first-time buyers, and investors, boasting a refitted and modern kitchen with built in appliances, a double bedroom, a useful study area, and a view over a green to the front. Refitted smart bathroom and allocated parking complete the package. Call now

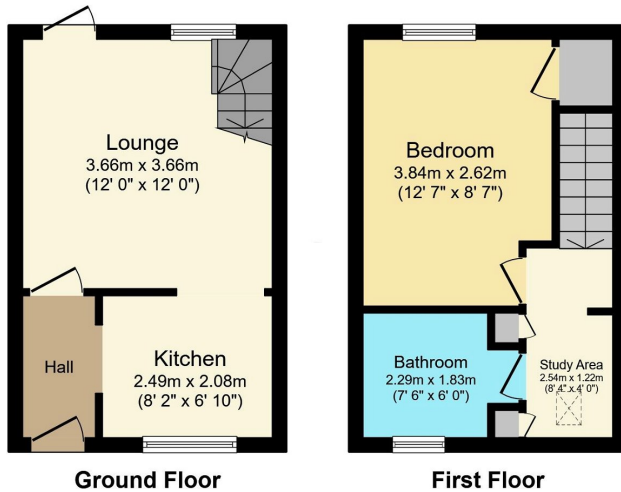

Total floor area 42.7 sq.m. (460 sq.ft.) approx
 This plan is for illustration purposes only and may not be representative of the property. Plan not to scale. Powered by PropertyBox

Score	Energy rating	Current	Potential
92+	A		
81-91	B		91 B
69-80	C	74 C	
55-68	D		
39-54	E		
21-38	F		
1-20	G		