



ADAM HALLIWELL POWERED BY **exp** TM UK

@ adam.halliwell@exp.uk.com

adamhalliwell.exp.uk.com

01242 906 586

Harrow Drive, Bishops Cleeve, Cheltenham, GL52

£112,000

🛏️ 2 🪑 1 🚗 1



- Please quote ref AH0137
- Two generous double bedrooms
- Two parking spaces
- Downstairs cloakroom
- Fitted kitchen with appliances
- 40% of the 100% value as shared ownership
- Potential to purchase higher amount of the whole value
- Generous bathroom with shower
- 2016 Built
- Bromford Housing owned Freehold



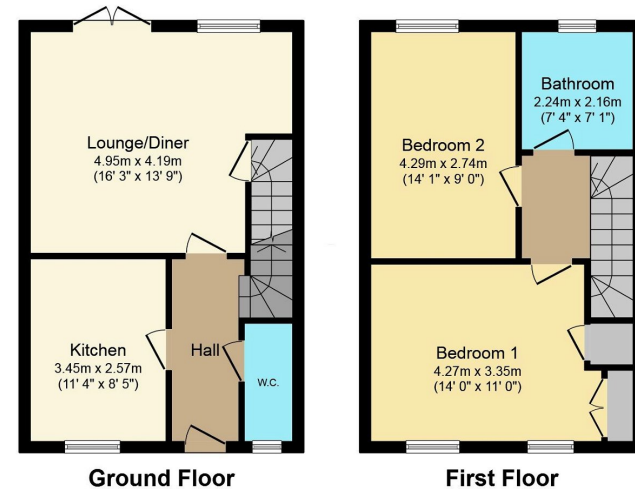

Total floor area 76.7 sq.m. (826 sq.ft.) approx

This plan is for illustration purposes only and may not be representative of the property. Plan not to scale. Powered by PropertyBox

40% Shared ownership sale in conjunction with Bromford Housing. This immaculate end of terrace property in an urban area offers comfort and style with two double bedrooms, a modern kitchen, landscaped garden, and convenient parking.

Score	Energy rating	Current	Potential
92+	A		
81-91	B	87 B	88 B
69-80	C		
55-68	D		
39-54	E		
21-38	F		
1-20	G		

eXp World UK Ltd is a registered company at Level 37, 25 Canada Square, London, E14 5LQ.

Registered company number is 12016573. VAT Registration Number is 327 4120 29