



ADAM HALLIWELL POWERED BY **exp** TM UK

@ adam.halliwell@exp.uk.com

adamhalliwell.exp.uk.com

01242 906 586

Cape Ruby Close, Bishops Cleeve, Cheltenham, GL52

£390,000

🛏️ 4 🍴 2 🚗 1



- Please quote Ref AH0137
- Open plan living space
- Garage
- 37' x 27' NT 18' Rear Garden
- Balcony with views
- Four bedrooms
- Cloakroom/utility room
- Master with en-suite
- Driveway
- EPC rating B

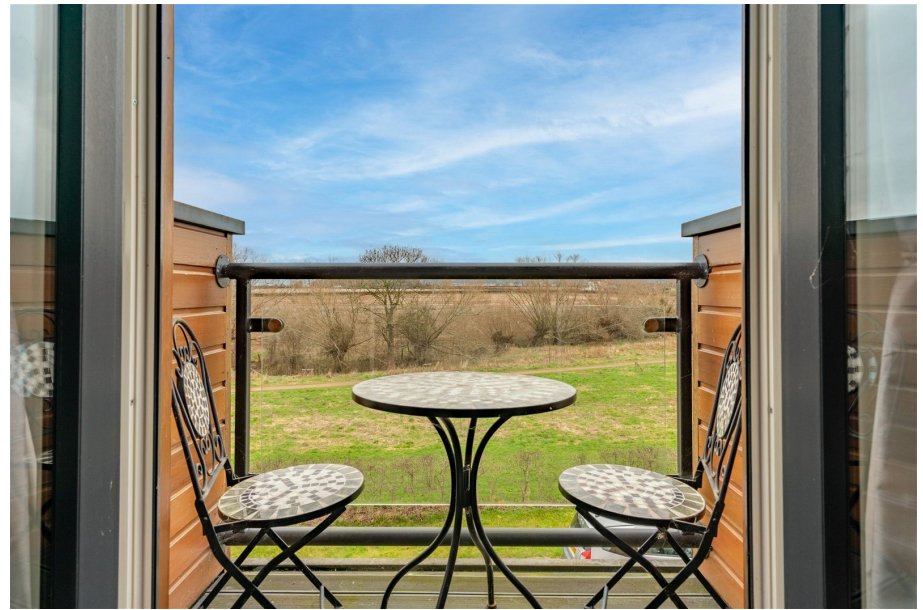

This delightful semi-detached house offers stunning views, an open-plan layout, and four bedrooms, making it an ideal family home in a convenient location. There is a cloakroom/utility, ensuite to the master (along with balcony), garage and southly facing rear garden. Call now for more information.

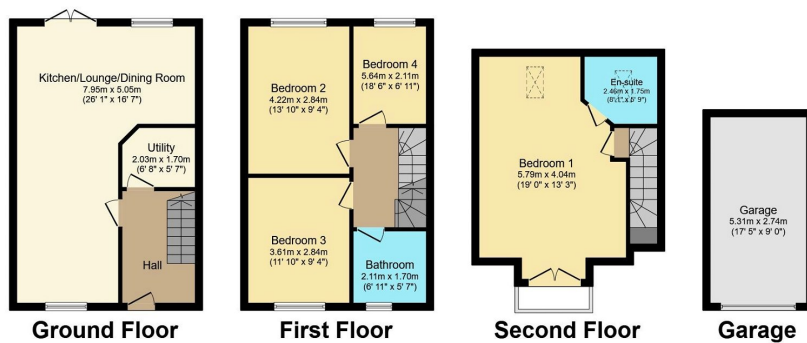

Total floor area 124.7 m² (1,342 sq.ft.) approx
 This plan is for illustration purposes only and may not be representative of the property. Plan not to scale. Powered by PropertyBox

Score	Energy rating	Current	Potential
92+	A		
81-91	B	87 B	88 B
69-80	C		
55-68	D		
39-54	E		
21-38	F		
1-20	G		