



ADAM HALLIWELL POWERED BY exp TM UK

@ adam.halliwell@exp.uk.com

adamhalliwell.exp.uk.com

01242 906 586

Selborne Road, Bishops Cleeve, Cheltenham, GL52

£325,000

🛏️ 2 🚿 1 🚪 1



- Please quote ref AH0137
- No onward chain
- Smart refitted shower room
- Gas central heating
- Driveway for two cars
- Two bedrooms
- Garage
- New roof covering 2022
- Double glazed
- 42' x 28' (max) rear garden



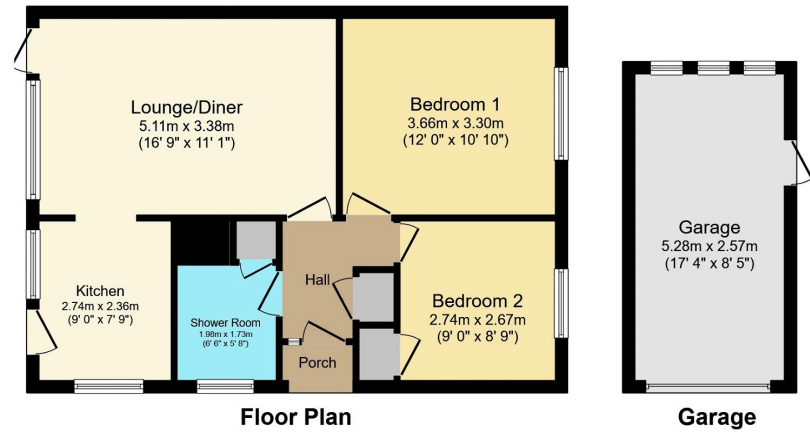

Total floor area 68.6 m² (739 sq.ft.) approx

This plan is for illustration purposes only and may not be representative of the property. Plan not to scale. Powered by PropertyBox

This immaculate semi-detached bungalow offers 2 bedrooms, an open-plan living room with garden access, and a detached garage with a double driveway, all in a convenient and desirable location close to shops and amenities.



eXp World UK Ltd is a registered company at Level 37, 25 Canada Square, London, E14 5LQ.

Registered company number is 12016573. VAT Registration Number is 327 4120 29