



ADAM HALLIWELL POWERED BY **exp**™ UK

@ adam.halliwell@exp.uk.com

adamhalliwell.exp.uk.com

01242 906 586

Royle Mews, Cowl Lane, Winchcombe, Cheltenham, GL54

£395,000

🛏️ 2 🍴 2 🚗 1



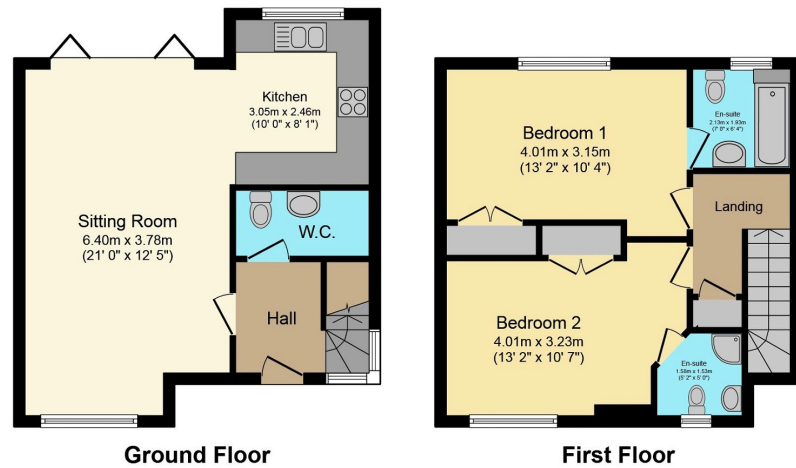

Total floor area 79.8 sq.m. (859 sq.ft.) approx
 This plan is for illustration purposes only and may not be representative of the property. Plan not to scale. Powered by PropertyBox



This immaculate property offers open-plan living, a private courtyard garden, and a convenient location in the centre of town, making it an ideal home for couples seeking modern and stylish living. Located in a private setting, just yards from the shopping and facilities with two double bedrooms and two bathrooms and parking, this property is offered for sale with no onward chain.

Score	Energy rating	Current	Potential
92+	A		93 A
81-91	B	82 B	
69-80	C		
55-68	D		
39-54	E		
21-38	F		
1-20	G		