



Mercian Court, 46 Park Place, The Park, Cheltenham, GL50

£120,000

2 1

A well presented 2nd floor retirement apartment for the over 55's in this established building on the Park in Cheltenham, ideally located for the Bath Road, Tivoli and Montpellier. The property has two bedrooms, a kitchen, a lounge and a shower room and is sold with no onward chain. Please call for your appointment to view.

Floor Area

510 sq. ft.

Tenure

Leasehold

Service Charge

£3740.94 per annum

Ground Rent

£96 per annum

- Please quote ref AH0137
- 2nd Floor apartment
- Residents' lounge
- Communal Laundry
- Lift
- Two bedrooms
- No Onward chain
- Minimum Age 55
- 24 hour emergency Appello call system
- Development Manager

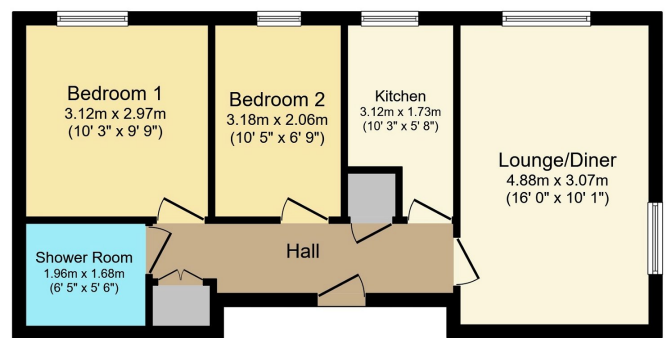

Floor Plan

Total floor area 47.4 sq.m. (510 sq.ft.) approx
 This plan is for illustration purposes only and may not be representative of the property. Plan not to scale. Powered by PropertyBox