



# Heron Wharf, Nottingham, NG7 1GF

£175,000

2 1

Introducing a charming two-bedroom mid-floor flat located in the desirable Castle Marina neighbourhood, situated in the vibrant NG7 1GF area. This delightful residence offers a comfortable and contemporary living space, perfect for individuals or a small family seeking a stylish urban retreat.

Don't miss out on the chance to make this stylish flat your new home. Contact us today to arrange a viewing and experience the charm of this delightful residence first hand.



Floor Area: 603 sq. ft.

Tenure: Leasehold

Service Charge: £1135.64 per annum

Ground Rent: £1 per annum

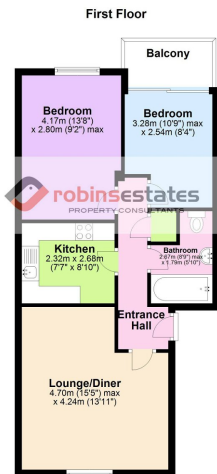

Give Erica or Angela a call on 0115 8240235  
Email us: [enquiries@robinsstates.com](mailto:enquiries@robinsstates.com)  
5 Derby Terrace, Derby Road, Nottingham, NG7 1ND

