

Your Logo

Kings Mews, Hexham, NE46 1BG

£150,000

🛏 2 🚿 2 🚗 1



****MODERN APARTMENT**TWO BEDROOMS**NO UPPER CHAIN**GARAGE**SHARED ROOF GARDEN**IMMACULATELY PRESENTED****

This modern second floor apartment, in a convenient location close to town centre and upgraded to a high standard is immaculately presented. It has the added benefit of gas central heating, new laminate flooring and carpets throughout and a single garage. The property has had a newly fitted modern kitchen and bathroom.

Your Logo

Key Features

- MODERN APARTMENT
- GARAGE & VISITOR PARKING
- TWO BATHROOMS
- IMMACULATELY PRESENTED
- SECURITY SYSTEM
- NO UPPER CHAIN
- TWO BEDROOMS
- CONVENIENT LOCATION
- MUST BE SEEN!
- JULIETTE BALCONY

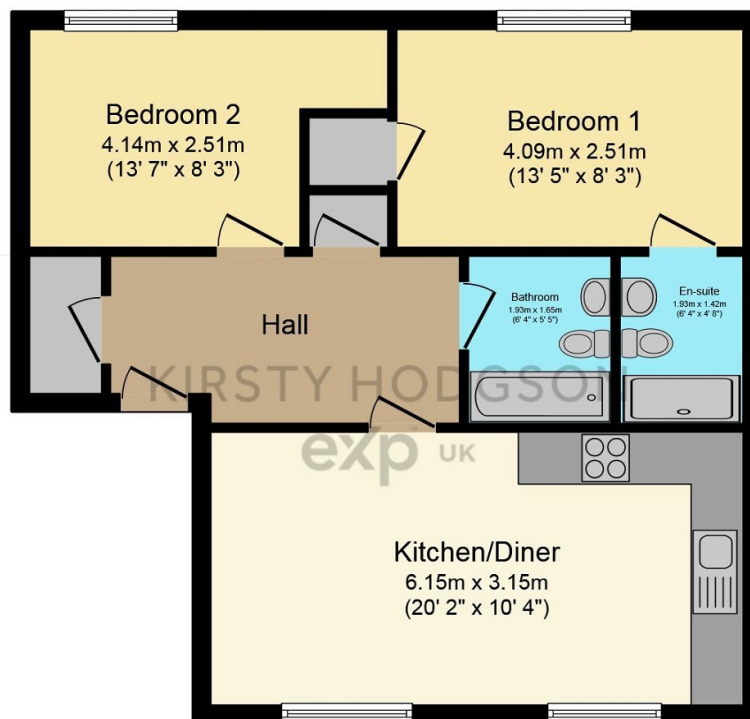

Floor Plan

This plan is for illustration purposes only and may not be representative of the property. Plan not to scale. Powered by PropertyBox